

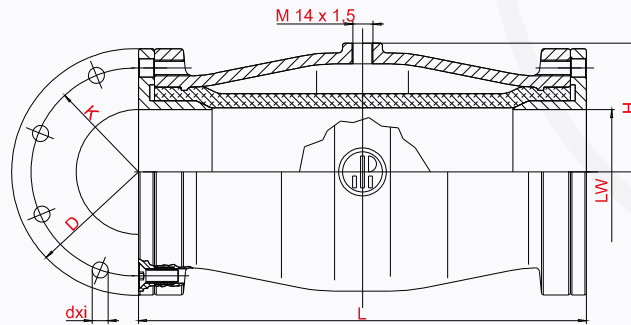

Products

Pinch Valve 520



PROKOSCH Pinch Valve No. 520

Dual-sided flange per DIN 28460.

The pneumatically activated PROKOSCH 520-series pinch valves were designed specifically for use in silo trucks. They are known for their strength, fewer individual parts and space-saving elements as well as their maintenance-free design. The free cylindrical pass reduces flow resistance to a minimum.

- ▶ Body made of a light alloy with generously dimensioned wall thickness. Flanges made of standard gray cast iron material. Each body is subjected to a burst test at 24 bar at the plant.
- ▶ Long service life due to highly abrasion-resistant sleeve made of NBR/SBR, fabric-reinforced and free cylindrical pass.
- ▶ Sleeve can also be provided in white food-substance quality and stainless steel flanges.
- ▶ Can be dismantled without special tools.
- ▶ Special designs regarding material and design are available upon request.

Nom. width DN	LW	Dimensions					Air pressure	weight (kg)
		L	D	K	dxi	H		
80	78	280	154	130	M10x8	81	5 - 6 bar	6,1
100	97	280	174	150	M12x8	91	5 - 6 bar	7,2

PROVEN & RELIABLE
FOR USE IN:

INDUSTRIAL

FUEL HANDLING

BULK HANDLING

TANK TRUCK CONSTR.

SILO TRUCK CONSTR.